

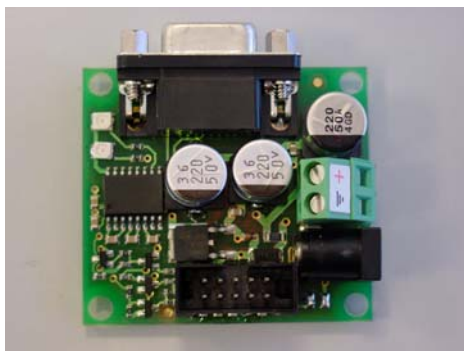

INTERFACE RS232-CCTALK

Installation and Set-up Manual



GRUPO AZKOYEN
Avda. San Silvestre s/n
31350 Peralta · Navarra · España
Tel.: +34 948 709 709 - Fax: +34 948 709 720
Web: <http://www.azkoyen.com>
E-mail: info@azkoyen.com

1. DESCRIPTION

The RS-232 to Cctalk interface PCB is used to control a device that utilizes Cctalk protocol using a PC application directly from the serial port.

The configuration parameters are as follows:

9600 baud, 1 start bit, 8 data bits, no parity, 1 stop bit.

2. COMPONENT LAYOUT AND BOARD DIMENSIONS

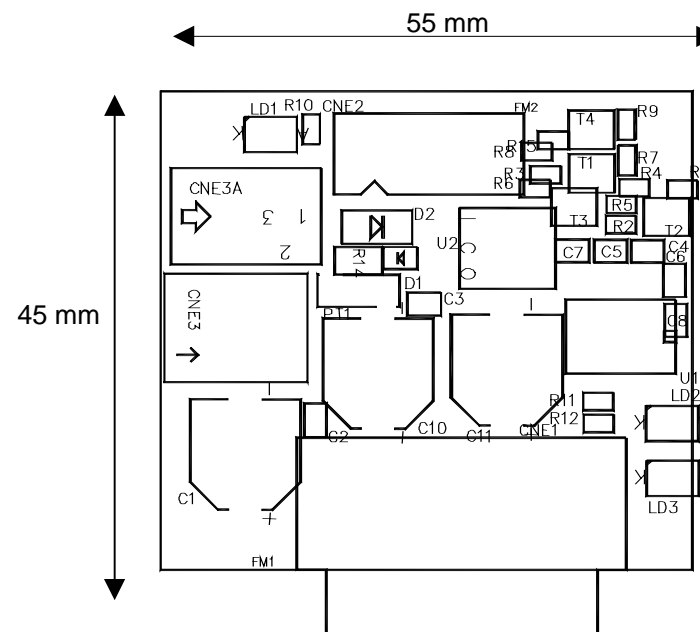

3. GENERAL CHARACTERISTICS AND CONNECTIONS.

The PCB requires 12Vdc or 24Vdc.

The current consumption is 100 and 150 mA respectively.

POWER CONNECTOR (CNE3):

PIN	DESCRIPTION
PIN1	12 or 24 Vdc.
PIN2	0V

RS232 CONNECTOR (CNE1):

PIN	DESCRIPTION
PIN1	Not Connected
PIN2	TXD
PIN3	RXD
PIN4	Not Connected
PIN5	GND
PIN6	Not Connected
PIN7	Not Connected
PIN8	Not Connected
PIN9	Not Connected

CCTALK CONNECTOR (CNE2):

PIN	DESCRIPTION
PIN1	DATA
PIN2	GND
PIN3	Not Connected
PIN4	GND
PIN5	Not Connected
PIN6	VCC-POT
PIN7	VCC-POT
PIN8	GND
PIN9	Not Connected
PIN10	VCC-POT

POWER SUPPLY :

TYPE	SWITCHING
INPUT	230 (115) Vac \pm 20%
OUTPUT	12Vdc and 24 Vdc
Nominal Current	5A Continuous