

9100 "IN-LINE" DOOR



Model 9101



Model 9102



Model 9101/DBV

- Accepts industry standard mechanical and electronic mechanisms
- Heavy duty 16 gauge steel drawn doors
- One piece aluminum die cast frame
- Large capacity cash box and shroud
- Embossed lock guards
- Durable textured paint finish
- Illuminated coin denomination/reject button (five colors available)
- Complies with industry standards

Options

- Domestic, token or foreign mechanical coin mechanisms available
- Electronic mechanisms
 - Coin Comparitor
 - Microcoin
 - Other multicoins mechanisms
- Dollar bill validator (designate model/manufacturer)
- Coin lockout coil (designate voltage)
- Three point locking cam system
- Coin counter, six digit non-resettable (designate voltage)
- Custom color paint



COIN MECHANISMS INC. *The Name in Validation Systems*

P.O. Box 5128, 400 Regency Drive, Glendale Heights, IL 60139-5128
630/924-7070 • 1-800/323-6498 In USA & Canada • FAX 630/924-7088

MODEL 9101



- Single slot door design
- Quick release mech removal
- Coin return flap for added security
- Attractive textured entry/return bezels

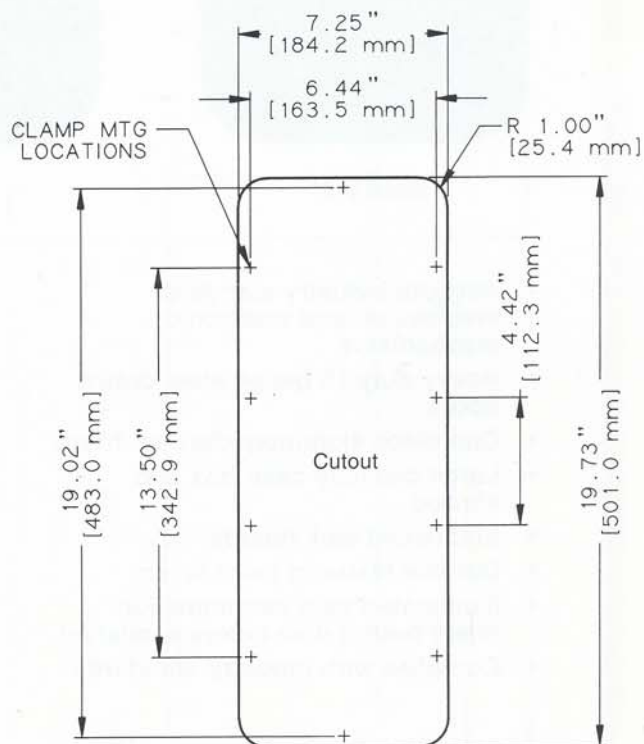
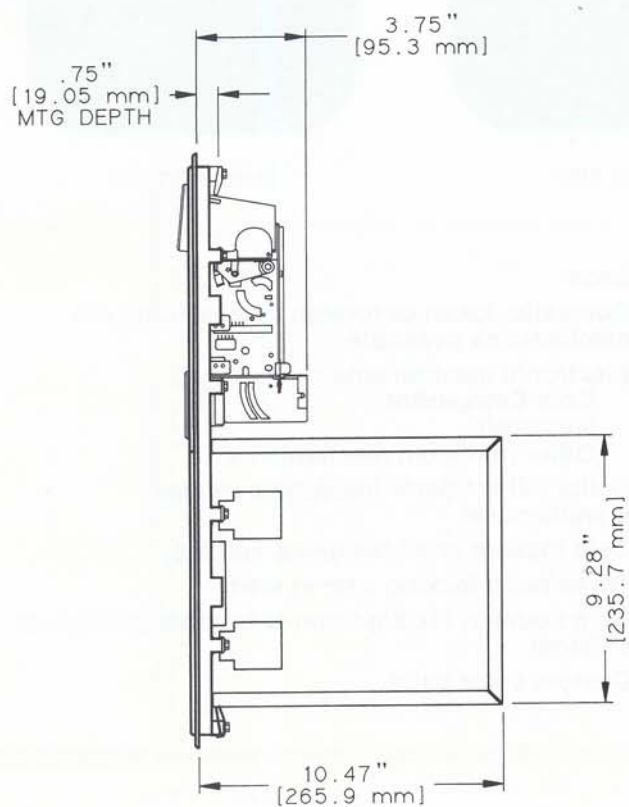
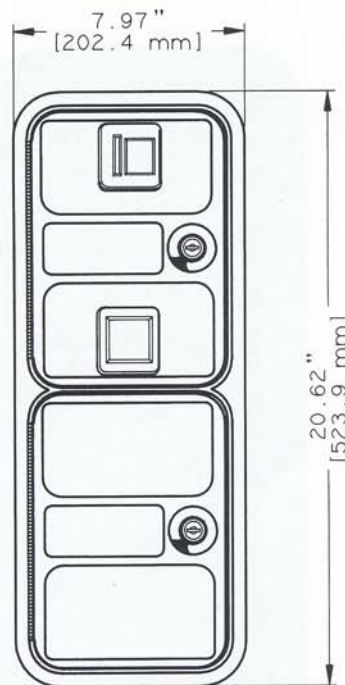



MODEL 9102

- Double slot door design
- Quick release mech removal
- Coin return flap for added security
- Attractive textured entry/return bezels
- Independent coin slots for reliability

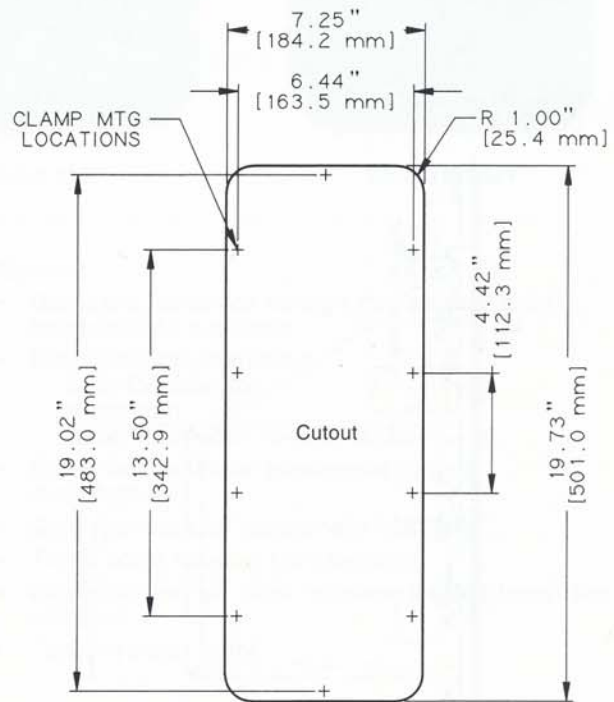
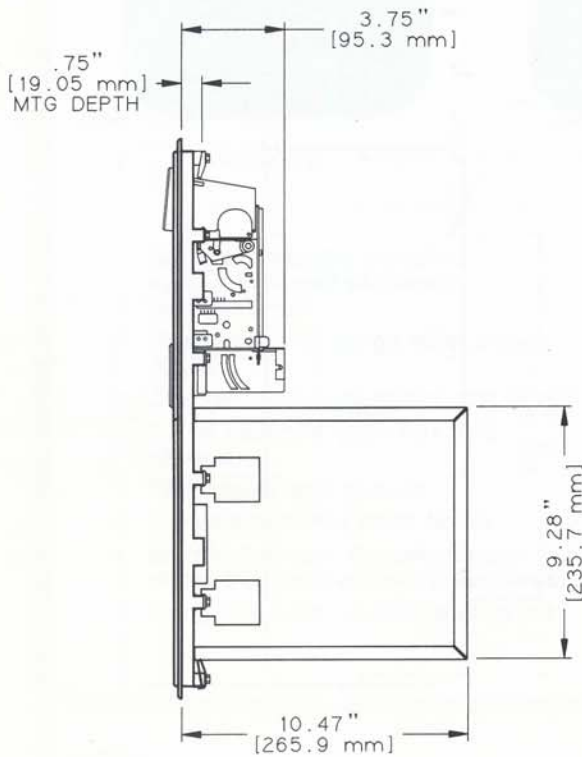
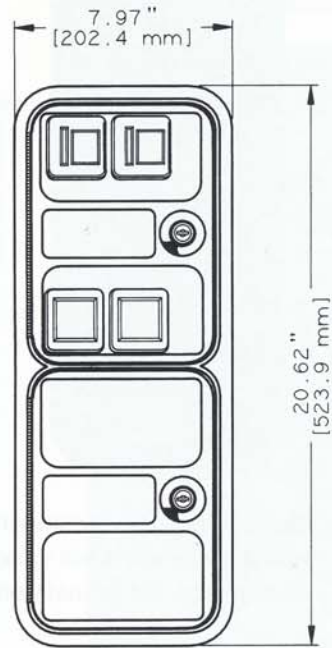

MODEL 9101/DBV



- Single slot door design with bill validator
- Industry standard bill validator mounting
- Hooded shroud funnels bills into cash box

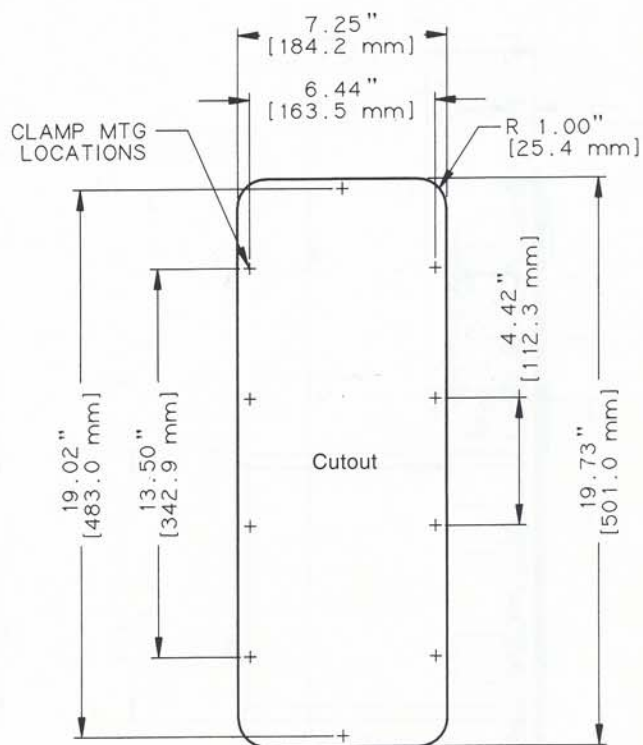
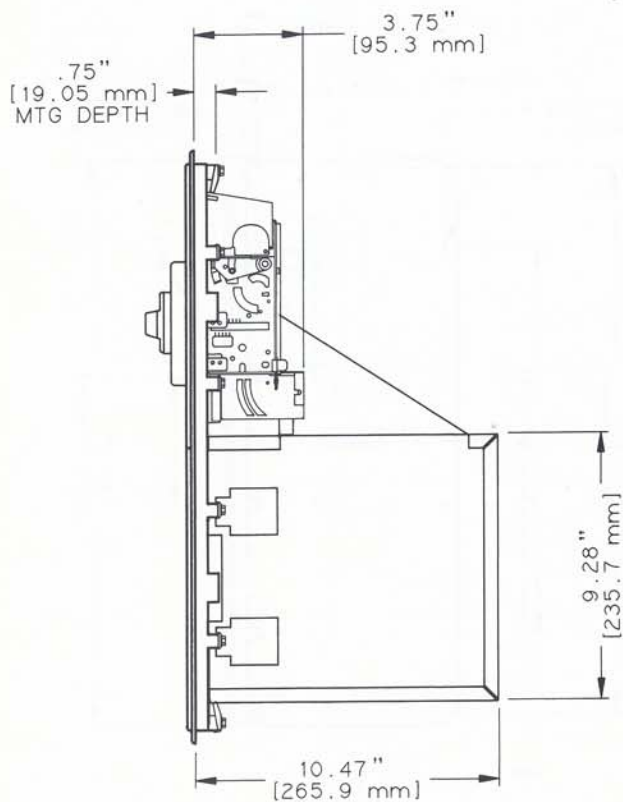
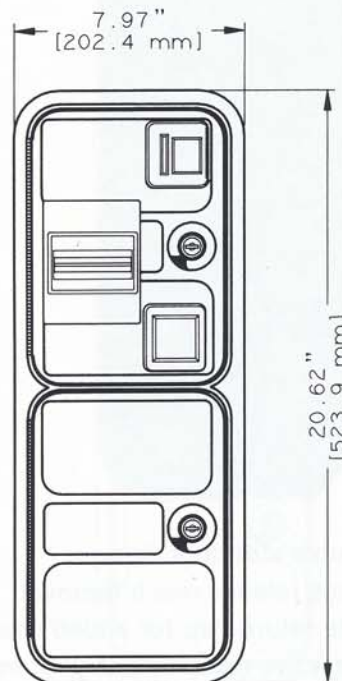

COIN MECHANISMS INC.